

Appendix 9

Proposed Site Levels and Water Management Approach



660797.489mE
774105.411mN

660629.301mE
7740682.489mN

BOODARIE STATION ACCESS ROAD

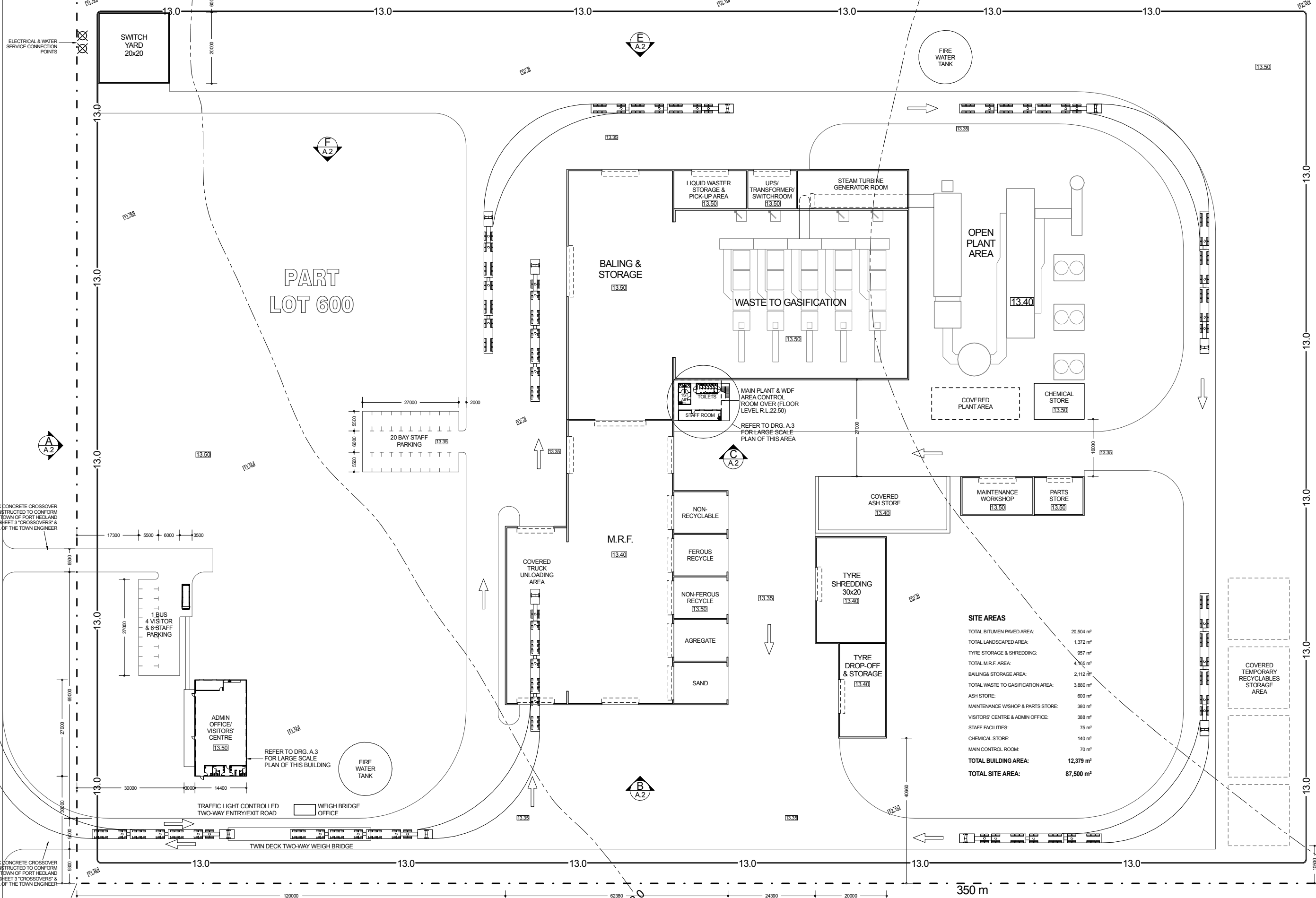

100 THICK CONCRETE CROSSOVER DESIGNED & CONSTRUCTED TO CONFORM WITH THE TOWN OF PORT HEDLAND INFORMATION SHEET 3 "CROSSOVERS" & THE APPROVAL OF THE TOWN ENGINEER

200 THICK CONCRETE CROSSOVER DESIGNED & CONSTRUCTED TO CONFORM WITH THE TOWN OF PORT HEDLAND INFORMATION SHEET 3 "CROSSOVERS" & THE APPROVAL OF THE TOWN ENGINEER

660570.662mE
7741150.529mN

660402.474mE
7740787.606mN

SITE AREAS

TOTAL BITUMEN PAVED AREA:	20,504 m ²
TOTAL LANDSCAPED AREA:	1,372 m ²
TYRE STORAGE & SHREDDING:	957 m ²
TOTAL M.R.F. AREA:	4,165 m ²
BALING & STORAGE AREA:	2,112 m ²
TOTAL WASTE TO GASIFICATION AREA:	3,880 m ²
ASH STORE:	600 m ²
MAINTENANCE WISHOP & PARTS STORE:	380 m ²
VISITORS' CENTRE & ADMIN OFFICE:	388 m ²
STAFF FACILITIES:	75 m ²
CHEMICAL STORE:	140 m ²
MAIN CONTROL ROOM:	70 m ²
TOTAL BUILDING AREA:	12,379 m²
TOTAL SITE AREA:	87,500 m²

- LEGEND**
- 13.50 EXISTING SPOT LEVEL
 - 13.40 CONTOUR LINE & LEVEL
 - 13.35 PROPOSED LEVEL
 - 13.00 PROPOSED LEVEL AT GEOFABRIC STABILISED PERIMETER

SITE NOTES

FINAL CIVIL WORKS & STORMWATER DESIGN TO BE SUBMITTED AT BUILDING LICENSE STAGE & CONFORMING WITH THE REQUIREMENTS OF THE APPROVED WATER MANAGEMENT PLAN FOR THE SUBDIVISION.

BOUNDARY TO HAVE CONTINUOUS 2400 HIGH LINK MESH FENCE WITH THREE ROWS OF BARBED WIRE AT TOP. CROSSOVERS TO HAVE AUTO CALLIBRE SLIDING GATES WITH ADJOINING PERSONNEL GATES.



ISSUED FOR DEVELOPMENT APPROVAL

PROJECT: PROPOSED WASTE TO GASIFICATION PLANT - BOODARIE, PORT HEDLAND

DATE: 30 JULY 2012

SCALE: 1:500 @ A1

DRAWN: [Signature]

ISSUE: [Signature]

DRG. NO: A.1

NEW ENERGY CORPORATION PTY LTD
SUITE 1, 12 PARLIAMENT PLACE
WEST PERTH WA 8005

gervas design
10 SHELLE ST
MAYLANDS WA 6051
P: 08 9460 3161
M: 0463 180 724
gervasdesign@net.net.au